



**Green Lion**

**Green Lion GWM-10 Portable  
WUDU Machine**

SKU: GNGW10PWUDWH

# Table of Contents

Features	2
Important Notes	2
Specifications	3
Used Water Discharge	3
Wash Body	4
When Used at Home	5
Warranty	5
Contact Us	5

Before installing and using the product, please carefully read this User Manual to guarantee correct usage and keep it secure for future reference.

## Features

1. **Portable Design:** Easy to transport and reassemble, ideal for varied locations.
2. **No Installation Required:** Ready to use without any setup, simplifying your experience.
3. **Lightweight:** Easy to move and handle, enhancing its portability.
4. **Pressure Foot Pedal:** Activate the washing process hands-free for hygienic and convenient cleaning.
5. **Safe to Use:** Engineered with user safety in mind for a risk-free operation.
6. **Eco-Friendly:** Designed to be environmentally conscious, reducing ecological impact.
7. **Foot Pedal Activation:** Initiates the washing cycle with a simple foot press, promoting hygiene and ease.
8. **Convenient Body Wash Sprayer:** Positioned to enable effortless full body cleansing.

## Important Notes

1. Lift the elastic faucet and rotate it clockwise at a 45-degree angle to align with the groove below, preventing water from splashing.
  2. After use, turn off the water switch before returning the faucet to its original position.
  3. Step on the foot pedal to activate the water flow from the spray nozzle for washing.
  4. Connect the Shattaf (handheld sprayer) to the faucet and turn on the switch for washing.
- Note:** The foot wash and hand wash functions should not operate simultaneously.

## Specifications

Model No.	GWM-10
Material	PP
Battery	1800mAh*2
Clean Water Capacity	2.5L
Used Water Capacity	2L
Working Time	1-3 Hours
Charging Time	6-7 Hours
Charging Voltage	DC 8.4V
Working Voltage	3.7V
Charging Current	1500mA
Charging Port	USB-A to DC
Working Current	1200mA
Product Dimensions	35×35×40.5 cm
Product Weight	4.7 kg

## Used Water Discharge

1. After completing the wash, pull the used water container out from the main body of the machine.
2. Locate the used water container. Unscrew the lid at the bottom.
3. Discharge the used water safely.
4. Ensure the container is securely positioned back in the machine after emptying.

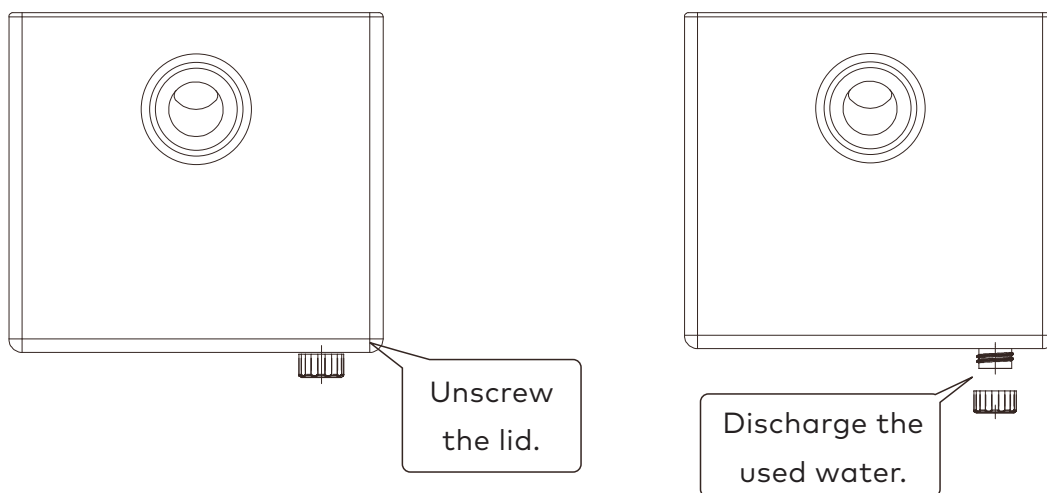
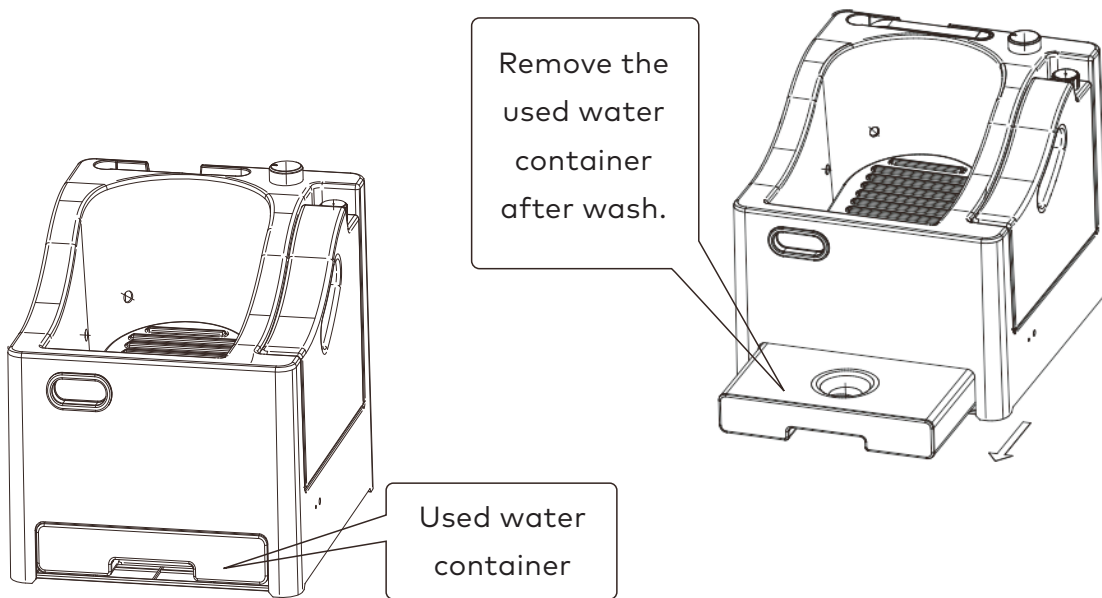

## Wash Body

The set includes a shattaf and hose. The shattaf can be connected to the built-in faucet for effective body washing and cleaning.

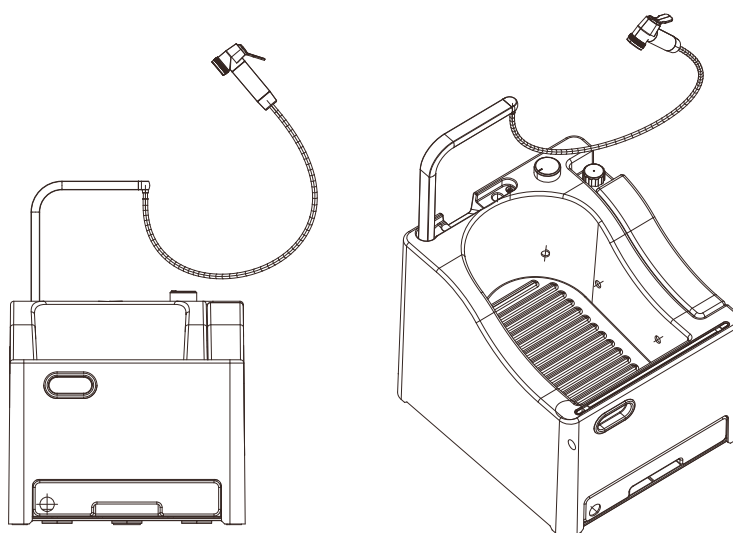

## When Used at Home

Connect the water outlet pipe to the drainage system. The used water will automatically drain when the machine is in use.

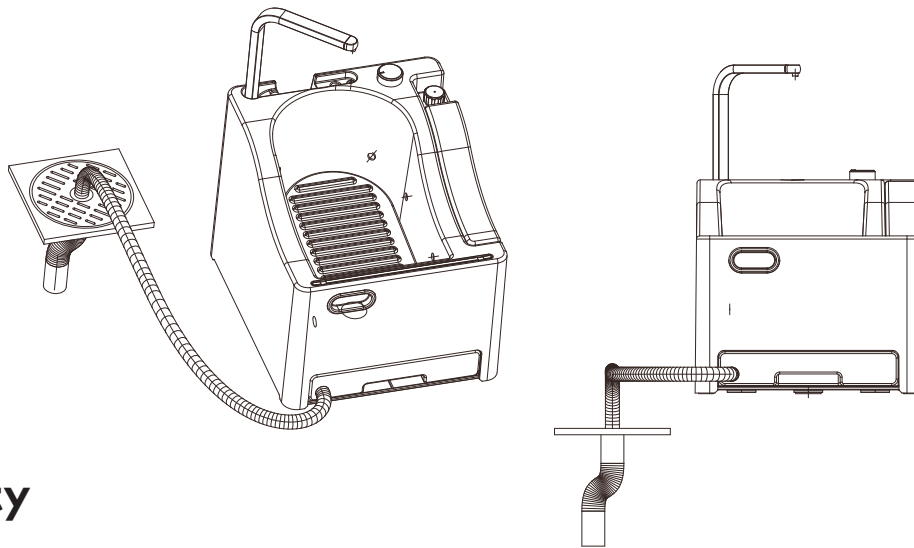

## Warranty

Products that you buy directly from our **Green Lion** website or shop come with a 24-month warranty.

When you buy **Green Lion** products from any of our approved sellers, you only get a 12-month warranty. If you want to extend this warranty, go to our website at <https://www.greenlion.net/warranty> and fill out the form with your information. Don't forget to upload a picture of the product too. After we've checked and accepted your request, we'll send you an email to confirm that your product's warranty has been extended.

For more info, please check:

<https://www.greenlion.net/warranty>

## Contact Us

If you have any questions about this Privacy Policy, please contact us at:  
Website: <https://www.greenlion.net/>

Sales: [sales@greenlion.net](mailto:sales@greenlion.net)

Service Support: [Support@greenlion.net](mailto:Support@greenlion.net)

Telegram: [@greenlion\\_global](https://t.me/greenlion_global)

Instagram: [@greenlion\\_global](https://www.instagram.com/greenlion_global)